

What is the Enercept SIP Building System?

At the heart of the Enercept SIP Building System is a simple, yet ingenious building product- structural insulated panels (SIPs). SIPs are formed from a high quality insulation, EPS (expanded polystyrene), laminated between OSB (oriented strand board). SIPs provide a fast, simple exterior framing system saving you time and money. The insulation and sheathing in SIPs bond to form a virtual I-beam of strength, protecting your home and family from weather conditions. With the Enercept SIP system you will experience a quieter, healthier home and a lifetime of energy savings.

Whether you have a plan in mind or need design assistance, the Enercept drafting and design team will work with you to create your dream home. Each panel is custom built for your specific home. The drawing below depicts a typical Enercept wall system, including custom fabricated rough openings and patented electrical chases. The complete Enercept SIP package includes basement walls, floor panels, wall and roof panels, and connection accessories.

“No Foam Scoop Required”

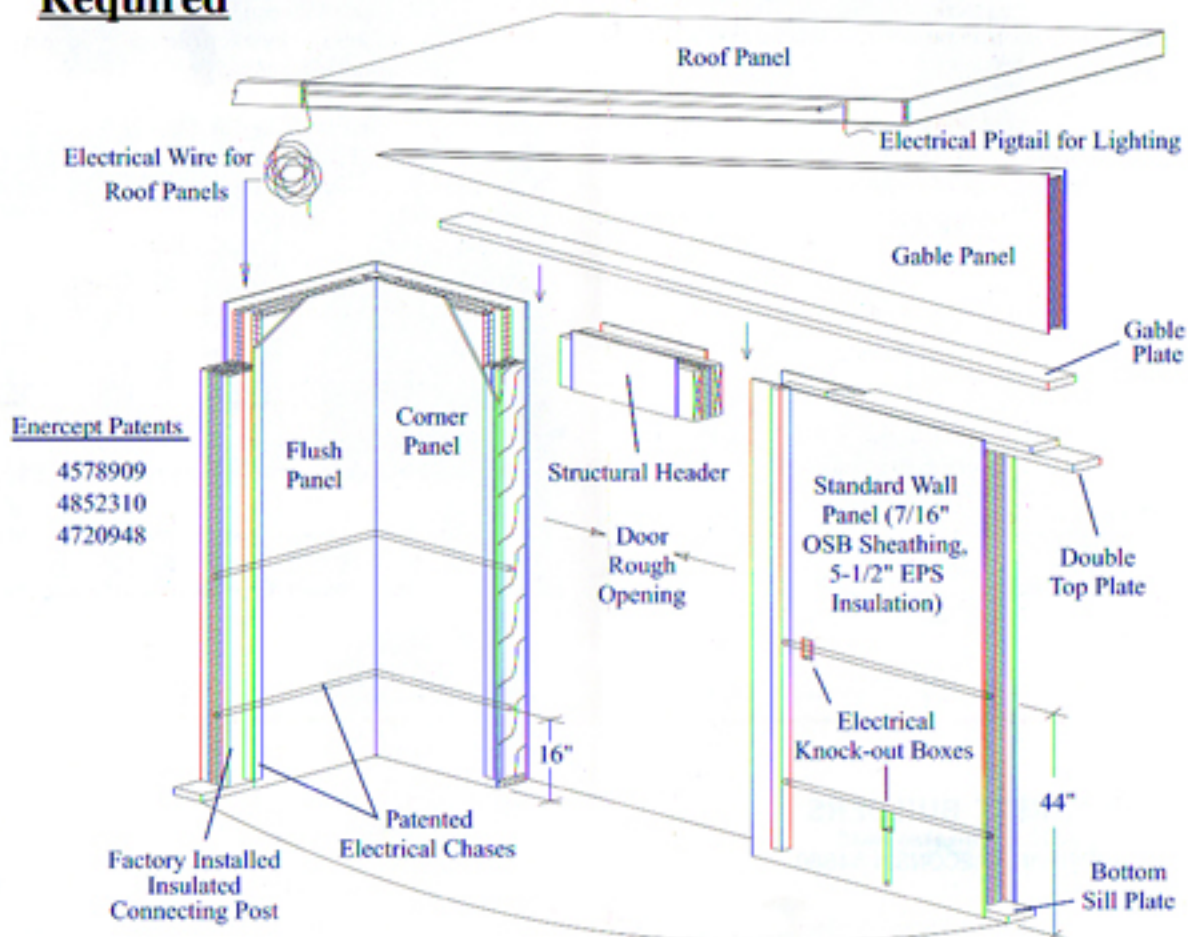

Fast ~ Simple Construction

The Enercept SIP system combines framing, insulation, and sheathing into one step. The result is faster framing time and less labor cost.

“It went together so easy, it only took 35 hours to put the structure up!” (two story, 2,016 sq. ft. home)

*James R Gunderson
Enercept Homeowner*

Energy Savings

The superb R-value of the EPS insulation in SIPs, results in an average savings of 50% in heating and cooling costs compared to conventional framing. Enercept is an allied member of the Energy Star Homes Program sponsored by the EPA. Enercept home buyers can qualify for mortgage perks, such as closing cost rebates and debt-to-income ratio stretches- allowing you to afford more home.

“I am heating my entire home (3600 sf), garage (800 sf), and sauna house (200 sf), for 11 cents per square foot per year! It is the best house I have ever built for myself, and I have built seven!”

*Norm Rihiluoma,
Tower, MN
2ndwind@uslink.net*

Heating Cost Comparison

two identical 1,040 sq. ft. homes

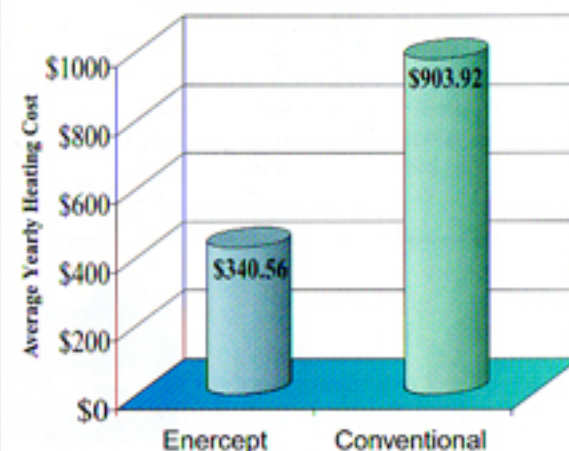

SIP Roof System

Enercept structural roof panels extend from the top of the wall system to the peak of the roof where they rest upon a beam system or a center bearing wall. The result is a vaulted ceiling, perfect for creating the impression of more space or a loft living area. Gable panels are custom fabricated to the precise pitch of your roof. All beams, wall-to-roof panel ties, and roof screws are included in the Enercept package. Roof panel thickness varies depending on design load and R-value requirements in your area.

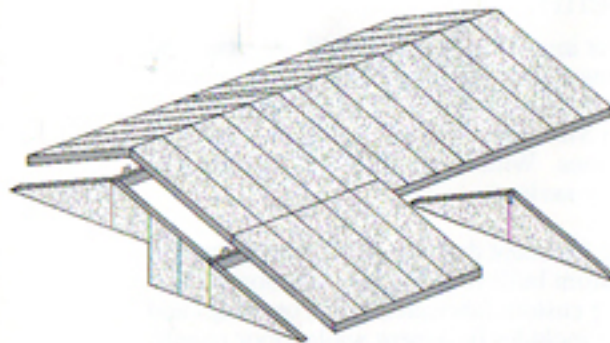

SIP Roof System

SIP Wall System

The Enercept wall system is comprised of 5-1/2" EPS insulation laminated between OSB sheathing. Panels are connected at the job site by a tongue and groove method with a factory-installed insulated post. All rough openings (windows and doors) are custom built and framed by Enercept. Electrical chases and knock-out boxes are provided with the Enercept patented system. Bottom sill plate, double top plates, and panel sealant are included. Enercept walls are compatible with typical types of windows, doors, siding and interior finishes.

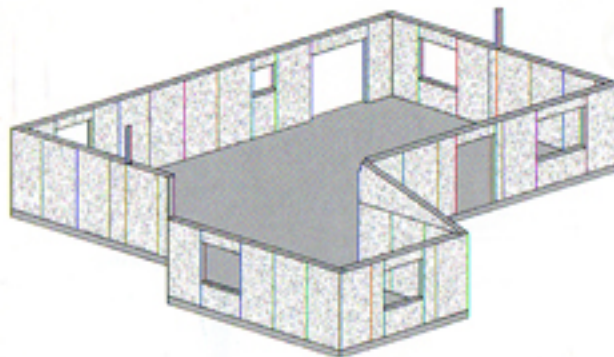

SIP Wall System

SIP Basement System

The Enercept basement system creates an insulated environment perfect for additional living space. Basement panels are composed of 7-3/8" EPS laminated to OSB on the interior and treated plywood on the exterior. Rough openings and electrical chases are provided similar to the Enercept above-grade wall system. Enercept also offers an insulated foundation system, excellent for protecting plumbing in cold climates.

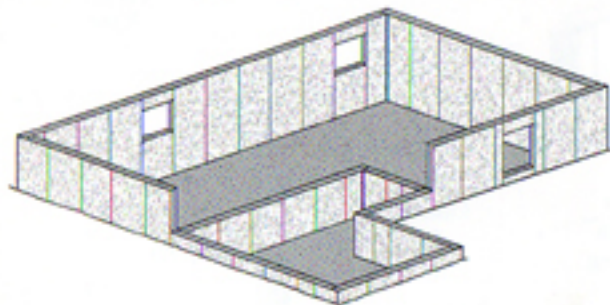

SIP Basement System

Panelize



Your



Dreams



ENERCEPT SIPS

STRUCTURAL
INSULATED PANELS



Enercept, Inc.
All rights reserved.
Copyright ©1999.



BARRETT BUILDERS
5002 E. Tri-Lakes Road
SUPERIOR, WISCONSIN 54880

Enercept Independent Dealer